



SANITOR

- FDA conform and ATEX exempt
- Large operating pressure range
 - Slow, constant rotation
 - No ball bearings, no plastic



- Hydrodynamic bearing
- Pressure range 2 - 20 bar
- Cleaning diameter up to 4.8 m
- Flow rate between 25 - 92 lpm
- Insertion opening BSP/NPT 32 mm
- Insertion opening Pin Fix 60 mm
- Maintenance free and durable

The Sanitor is a compact liquid-bearing rotating nozzle consisting of only 3 stainless steel components. From a liquid pressure of at least 2 bar, the stainless steel rotor is lifted by liquid and begins to rotate slowly. Flat, overlapping liquid jets are generated through liquid outlet openings. The jets of liquid create a strong impact effect which is enhanced by the slow rotation.

The all-stainless steel construction of the Sanitor makes it extremely temperature resistant. The Sanitor is ideally suited as a replacement for fixed spray balls. The Sanitor can be driven flexibly in the range of 2 to 20 bar liquid pressure and reaches a cleaning diameter of up to 4.8 metres.

Without ball bearings and without plastic components, FDA compliant and suitable for EX zones. The Sanitor is available with 360° spray pattern and 3/8" BSP/NPT or 1/2" split pin attachment.

Pipe Connection	Spry pattern	Pipe*	Product code	Materials	Certificates	Article number
3/8" IG BSP	360°	3/8"	SANITORAF-360-BSP	316L	ATEX+FDA, 3.1	4660-3002-010
3/8" IG NPT	360°	3/8"	SANITORAF-360-NPT	316L	ATEX+FDA, 3.1	4660-3003-010
1/2" Splint	360°	12,70	SANITORAF-360-PF	316L	ATEX+FDA, 3.1	4660-3001-010

*corresponds to the max. pipe outer diameter of the pipe on which the machine is to be installed (inch or mm).

Split pin versions have approx. 15% higher flow. Hastelloy C22 and other materials on request.

Technical data:

Max. cleaning diameter:	4.8 meter (15.7 ft)
Spray pattern:	360°
Pressure range:	2 – 20 bar (29 – 290 psi)
Flow rate:	25 – 92 LPM (1.5 – 5.5 m³/h) (6.6 – 24.3 US gpm)
Insertion opening:	BSP/NPT min. Ø 32 mm (1.26 Inch), Splint min. Ø 60 mm (2.36 Inch)
Preferred mounting position:	vertical down preferred
Weight:	approx. 0.17 KG (0.37 lbs)
Materials:	Stainless Steel 316L (1.4404)
Pipe connection:	3/8" BSP (NPT) female
Optional Pipe Connections:	1/2" OD Splint (12.7x1.6 mm)
Nozzle characteristics:	Ball with slots
Certifications:	3.1, 2.2, ATEX, FDA, Regulation (EC) No 1935/2004
Max. operating temperature:	95°C (203°F)
Max. ambient temperature:	140°C (284°F), 30Min.

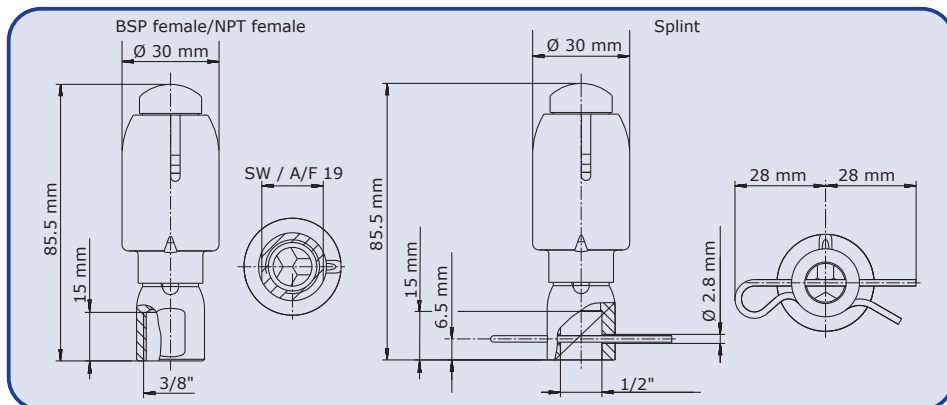
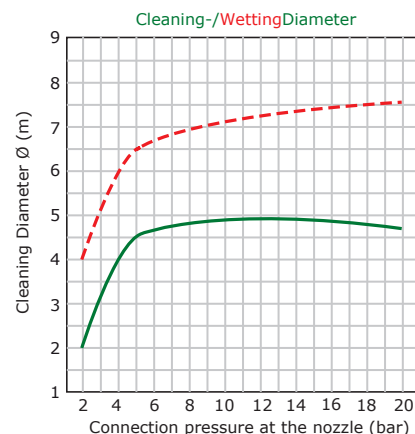
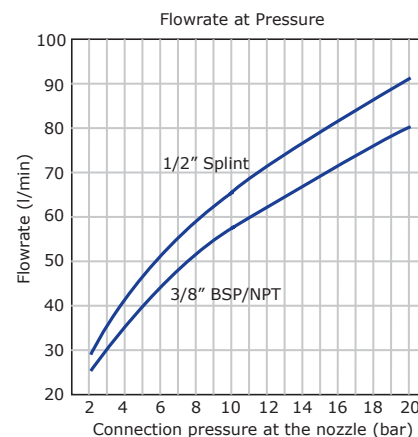

The data, technical data and information presented do not release the user from the obligation to check the suitability of the products supplied for the intended application. All information is without guarantee. (Status: 28.02.2022-71427321893-1888948-71042)