

CYCLONE

- High-Speed wash
- Low Flow Rates
- Low pressure operation
- Compact design

- Hygienic and compact design
- Pressure range 4 – 10 bar
- Cleaning diameter up to 14 m
- Flow rate between 42 – 103 lpm
- Insertion opening 80 mm
- Driven by the cleaning medium
- Ball bearing free, Self-cleaning
- Monitoring with sensor SMW 100 or Veri-Clean

The CYCLONE is an extremely small target jet cleaner with orbital 360° spray pattern. An installation opening of only 80 mm is required to install a Cyclone. The Cyclone is driven by the cleaning medium at a pressure of 4 to 10 bar. Turbine-driven, a radial and axial rotation of the nozzle head is generated. This produces jets of liquid directed through four nozzles with a strong impact effect up to a diameter of 14 metres. By circulating liquid jets, a completing spray pattern with full coverage is thus achieved within 3.5 to 6 minutes.

Thanks to optimal flow control, a smooth-running mechanism without ball bearings and a hygienic sealing concept, the energy used on the unit unfolds into a powerful cleaning effect. The orbital cleaning behaviour enables the best possible use of the cleaning liquid or chemical additives. For use in hygiene-sensitive areas, the unit keeps itself permanently clean with a self-cleaning nozzle and empties itself automatically after use in vertical operation. The use of the unit is always resource-saving and requires minimal wear and maintenance.

The CYCLONE meets the highest hygiene and safety standards and is suitable for use in EX zones and FDA applications at the same time. During a long service life, this unit will always prove to be a reliable partner for your cleaning tasks. Cyclone orbital cleaners are available in different connection variants. Optionally, the cleaning process of a Cyclone can be permanently and non-invasively monitored by SMW 100 or Vericlean. The Cyclone is one of the latest and most effective developments on the market for cleaning technology.

Frequent areas of application for this product are tanks and containers in the brewing, beverage, dairy processing, food, pharmaceutical, chemical and transport industries.

Technische Daten:

Max. cleaning diameter:	14 meter (45.9 ft)
Spray pattern:	360° orbital
Pressure range:	4 – 10 bar (58 – 145 psi)
Flow rate:	42 – 103 LPM (2.5 – 6.2 m³/h) (11.1 – 27.2 US gpm)
Insertion opening:	min. Ø 80 mm (3.15 Inch)
Preferred mounting position:	any angle
Weight:	approx. 2.0 KG (4.4 lbs)
Materials:	Stainless Steel 316L (1.4404), C.PTFE, PTFE, C.PEEK
Pipe connection:	3/4" BSP (NPT) female
Optional Pipe Connections:	1" OD Splint (25.4 x 1.6mm)
Nozzle characteristics:	4 x 3.0 mm, 4 x 4.0 mm nozzles
Certifications:	3.1, 2.2, ATEX, FDA, Regulation (EC) No 1935/2004
Max. operating temperature:	95°C (203°F)
Max. ambient temperature:	140°C (284°F), 30Min.

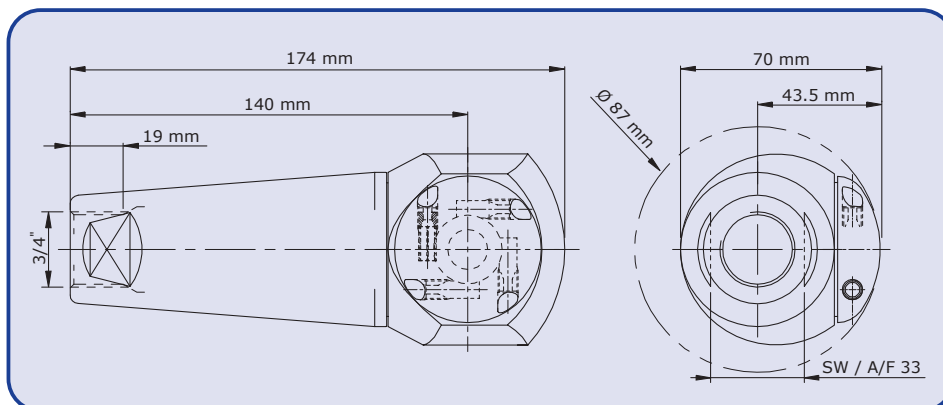
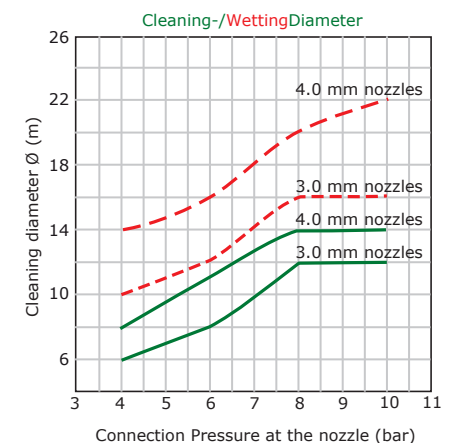
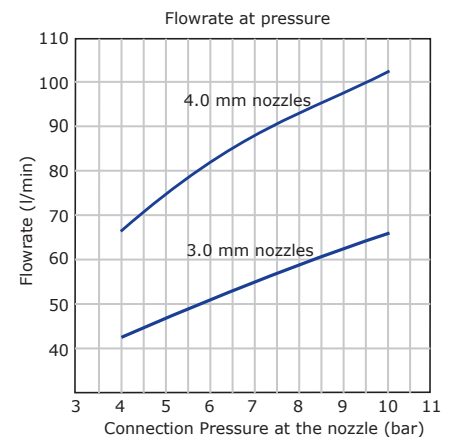

The data, technical data and information presented do not release the user from the obligation to check the suitability of the products supplied for the intended application. All information is without guarantee. (Status: 23.01.2022-71427321893-1888948-71042)